

3P Technik UK Filter System

Innovative Rainwater Harvesting



3P Rainus

Rainwater Filter for downpipe installation



Installation
Installation-Instructions

Operating
Operating-Instruction

3P Rainus

Please read the Instructions for the Installation and use of your 3P Rainus rainwater filter carefully and note the advice.

Contents List	Page
1. Technical Data	_02
2. How it Works	_03
3. Typical applications	_04
4. Installation Advice	_05
5. Filter Cleaning	_06
6. Winter Operation	_07
7. Quarantee	_08

1. Technical Data

The 3P Rainus can be installed in Down Pipes with following diameters:

- Ø 110
- Ø 100
- Ø 80

Adaptors facilitate a wider range of connections.

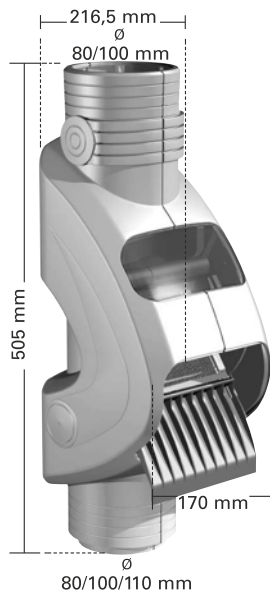

3P Rainus

2. How it Works

The filter is installed in the Downpipe, ①
Falling rainwater weirs over the lip of a small sump and on to the first filter cascade. ②
The 3P Rainus doesn't require a sewer (waste water) connection. The dirt passes out of the front of the filter. ③
The cleaned water passes out of the filter outlet, to the system's point(s) of use or to storage. ④

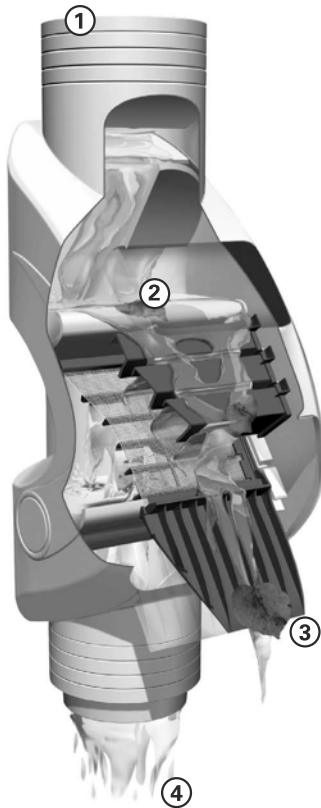

3. Typical Applications

The 3P Rainius is suitable for cleaning rainwater in the following systems:

- a. soakaway systems*
- b. rainwater harvesting systems
- c. retro fitting to existing tanks and water butts
- d. rainwater storage and flow regulation systems
- e. ponds and water features
- f. as sand and sludge trap (silt trap)

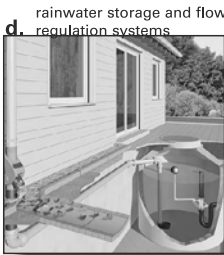
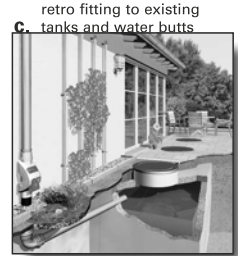

* Soakaway systems (Infiltration) are closed systems, so whilst filtering can enhance such systems life spans, an eventual possible failure can't always be assured.

4. Installation Advice

General Advice:

To ensure proper operation the 3P Rainus must **always** be installed vertically.

We recommend installing the filter at as low a height as possible. This ensures any ejected water causes the minimum nuisance, and is easily managed.

(But note the sieve unit has to be easily accessible for maintenance).

To manage the ejected water we recommend consideration of a small gutter or a gentle slope away from the house wall, (picture a/b/d, page 4) to avoid any damp build up to the building. Experience shows in some cases that a small sheet installed below the gutter area will assist in dispersing the ejected water. Alternatively a small gravel patch below the dirt outlet can be used as a soakaway for the ejected water.

Installation

1. Cut the standing downpipe 20 cm above the ground surface (gutter, gravel). Shorten the upper pipe according to the dimensions shown in the picture. Pay attention to make a horizontal cut and file the cut edge smooth.

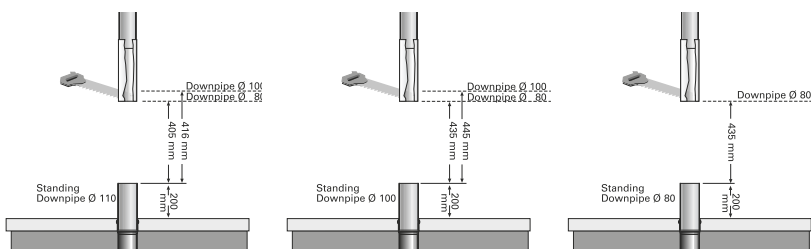

2. Push the upper downpipe section upwards, set the filter on the lower standing pipe and push the upper downpipe in.

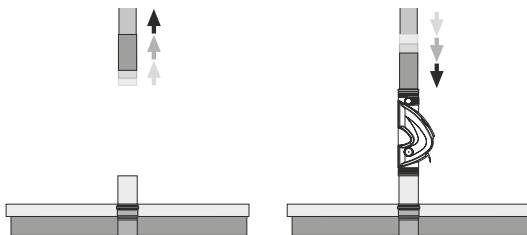

5. Filter cleaning

Regularly Monitor the Operation of the Rainus!

If too much ejected water sprays out we recommend you clean the sieve area.

1. To Remove the sieve

First push the tongue of the filter insert slightly upwards and then pull out to withdraw the sieve frame

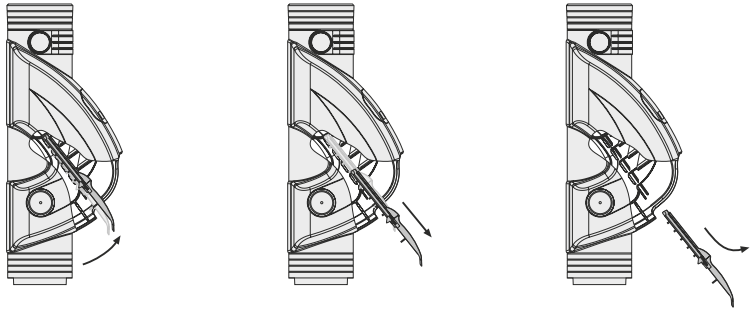

2. To clean the sieve

Clean the sieve with a brush under running water. From time to time use washing up liquid to remove any fatty deposits (e.g. waste gas from heating boilers).

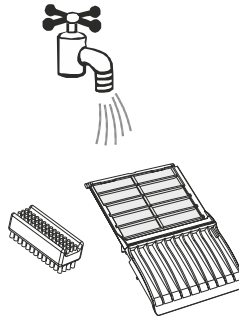

3. To reset the sieve

Push the frame back in the guide rail slots until it reaches the end and then press gently downwards. Once the sieve frame is engaged the filter will work again.

6. Winter Operation

Before periods of intense freezing weather the following issues should be considered:

The 3P Rainus should be protected from frost when, if there is no sewer connections, there will not be enough warm air in the down pipe or when the filter is installed in areas with strong winter frosts.

In freezing sunny clear weather and heavy frosts, melting snow can melt and refreeze repeatedly (the same weather situation when Icicles form). In such extreme conditions, both the filter or Downpipe can be damaged without protection. Also the melt water can be ejected and refreeze.

Many solutions and options are available:

1. Take out the filter insert (see point 5, Filter cleaning) and close the lower opening with the enclosed Cover (A). This is usually enough for protection but in extreme winters filter additional protection can be made:

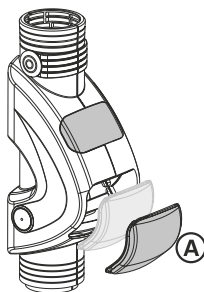

2. Completely remove the 3P Rainus and insert a piece of pipe in the gap or
3. Low voltage heating devices can be safely used to protect the 3P Rainus.

3P Technik UK Filter System

Innovative Rainwater Harvesting



3P Rainus

Rainwater Filter for downpipe installation

7. Guarantee

3P Technik Filtersysteme GmbH offers the guarantee required in law for this product (from date of purchase).

This guarantee covers all essential defects of the filter arising from inadequate materials or manufacturing faults.

It is given by a substitute delivery of a new, working filter or by a fee free repair of the returned filter of our choice, if following conditions are fulfilled:

- The 3P Rainus was handled as advised in the installation advice.
- Neither the customer nor any third party tried to repair the filter.

The producer Guarantee in no way affects the existing agent/ seller guarantee, and is in addition to your normal statutory rights.

3P Technik UK

Unit 9

Parc Teifi

Cardigan

SA43 1EW

Tel:01239 623506

Sales@3ptechnik.co.uk

www