

Twin and Triple Coil Cylinders

Key Features:

- Capacities from 250 to 500 litres
- Reduced height for easier installation
- Available with 1 or 2 primary heat exchangers in addition to the solar heat exchanger
- All models supplied with two high quality 3kW immersion heaters that can act as a backup heating
- Encased in enamelled galvanised steel outer casing
- Low maintenance
- 10-year guarantee on inner vessel
- 50mm insulation: HCFC and CFC-free polyurethane foam for low standing heat loss
- Available with or without a cylinder kit



Guarantee Inner Vessel¹

10 Years

Reduced Emissions

Conventional Heat Source Backup

Introducing Compact SS

Compact SS cylinders have been specifically developed for use with solar thermal applications. In addition to purpose-designed solar coil providing maximum heat transfer or renewable energy into the stored water, the cylinders feature one or two coils which can be connected to a traditional gas or oil boiler.

Compact SS are manufactured from high quality Duplex stainless steel, offering superior corrosion resistance and long operational life. Available in capacities ranging from 250 to 500 litres, they boast a special shorter design with wider diameter for easier installation.

Suitable for large domestic and light commercial applications, the cylinders can be used with a wide range of solar panels available on the Irish market.

Optional Cylinder Kits

The cylinders are available with an optional kit comprising of market leading components that we recommend.

KIT Code	Cylinder size
KIT24ROI	250L & 300L
KIT35ROI	400 & 500L



INLET
CONTROL SET
(22mm Compression)
(15mm Compression on PRV)



EXPANSION VESSEL
18L vessel on 250L cylinders
24L vessel on 300L cylinders
35L vessel on 400 & 500L cylinders



THERMOSTATIC
CONTROL
Dual Thermostat



TWO-PORT
VALVE
(22mm Compression)



ACETAL
TUNDISH
(22 x 15mm Compression)



TEMPERATURE &
PRESSURE RELIEF VALVE
(1/2" BSP x 15mm Compression)

¹ See installation instructions for full terms and conditions, only 2 years for parts.

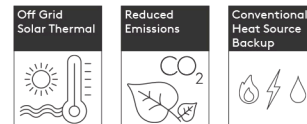

Compact SS Twin Coil

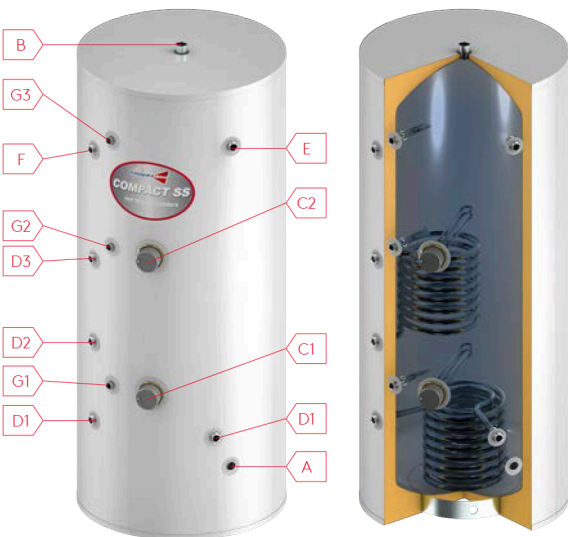

Connections

- A.** 1" BSP female thread cold feed
- B.** 1" BSP female thread hot water outlet
- C1.** Immersion heater†
- C2.** Immersion heater†
- D1.** 3/4" BSP male thread coil 1 connections (solar)
- D2.** 3/4" BSP male thread coil 2 connections (return)
- D3.** 3/4" BSP male thread coil 2 connections (flow)
- E.** 1/2" BSP Female boss
- F.** 3/4" BSP male thread secondary return
- G1.** Dry stat pocket (solar)
- G2.** Dry stat pocket (boiler)
- G3.** Dry stat pocket (high limit)

Factory fitted



Immersion Heater
3kW - 14"

Basic information

Code	Nominal Cap. (L)	Height (mm)	Dia. (mm)	ErP Rating	Standing Loss (W)
ROI2C250ERP	250	1350	625	C	76
ROI2C300ERP	300	1550	625	C	91
ROI2C400ERP	400	1650	694	C	101
ROI2C500ERP	500	1950	694	C	110

Connection locations

Nominal Cap. (L)	A (mm)	B (mm)	C1 (mm)	C2 (mm)	D1 (mm)	D2 (mm)	D3* (mm)	E (mm)	F (mm)	G1 (mm)	G2 (mm)	G3 (mm)
250	250	1345	435	916	840	360	360	1108	1047	435	916	1108
300	252	1550	533	1018	361	643	940	1308	1249	533	1018	1308
400	252	1650	522	1025	367	650	949	1410	1346	522	1025	1410
500	252	1950	522	1388	367	943	1311	1701	1639	522	1388	1701

Technical information

Nominal Cap. (L)	Actual Cap. (L)	Dedicated Solar Vol. (L)	Weight empty (kg)	Heat-up Time (min)	Coil 1 (kW)	Coil 2 (kW)	Heat Loss (kW/24h)	3kW immersion heater
250	250	110	65	40	2200	21.00	1.83	2x Standard
300	300	115	70	45	17.24	12.00	2.09	2x Standard
400	397	121	85	64	17.00	11.50	2.42	2x Standard
500	495	151	95	78	16.80	12.00	2.64	2x Standard

‡ Not to be used as the primary heat source
 * Note the heat pump coil connections on 250L model run horizontally not vertically, either connection may be used as flow/return

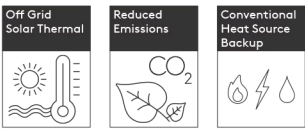

Compact SS Triple Coil

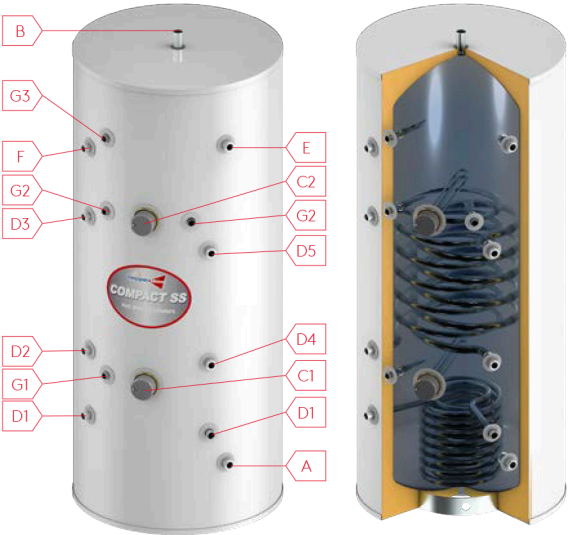

Connections

- A.** 1" BSP female thread Cold feed

B. 1" BSP female thread Hot water outlet

C1. Immersion heater†

C2. Immersion heater†

D1. 3/4" BSP male thread coil 1 connections (Solar)

D2. 3/4" BSP male thread coil 2 connections (Return)

D3. 3/4" BSP male thread coil 2 connections (Flow)
- D4.** 3/4" BSP male thread coil 3 connections (Return)

D5. 3/4" BSP male thread coil 3 connections (Flow)

E. 1/2" BSP Female Boss

F. 3/4" BSP male thread Secondary return

G1. Dry stat pocket (solar)

G2. Dry stat pocket (boiler)

G3. Dry stat pocket (high limit)

Factory fitted



Immersion Heater
3kW - 14"

Basic information

Code	Nominal Cap. (L)	Height (mm)	Dia. (mm)	ErP Rating	Standing Loss (W)
ROI3C300ERP	300	1550	625	C	91
ROI3C400ERP	400	1650	694	C	101
ROI3C500ERP	500	1950	694	C	110

Connection locations

Nominal Cap. (L)	A (mm)	B (mm)	C1 (mm)	C2 (mm)	D1 (mm)	D2 (mm)	D3 (mm)	D4 (mm)	D5 (mm)	F (mm)	G1 (mm)	G2 (mm)	E & G3 (mm)
300	252	1550	533	1018	361	643	940	640	1045	1246	533	1018	1308
400	252	1650	522	1025	367	650	949	619	1024	1346	522	1025	1410
500	252	1950	522	1388	367	943	1311	934	1339	1639	522	1388	1701

Technical information

Nominal Cap. (L)	Actual Cap. (L)	Dedicated Solar Vol. (L)	Weight empty (kg)	Heat-up Time (min)	Coil 1 (kW)	Coil 2 (kW)	Coil 3 (kW)	Heat Loss (kW/24h)	3kW immersion heater
300	300	115	70	45	17.24	12.00	12.00	2.09	2x Standard
400	397	121	85	64	17.00	11.50	11.50	2.42	2x Standard
500	495	151	95	78	16.80	12.00	12.00	2.64	2x Standard

† Not to be used as the primary heat source